

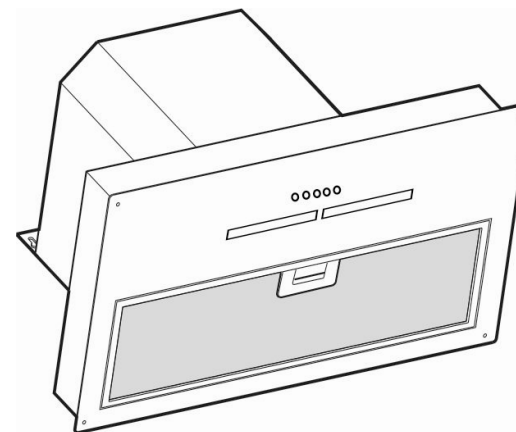

## **PUM60X & PUM90X RANGE HOOD INSTRUCTION MANUAL**



Thank you for your purchase of this product. Please read the manual carefully before operating the appliance.

## Installation Diagram

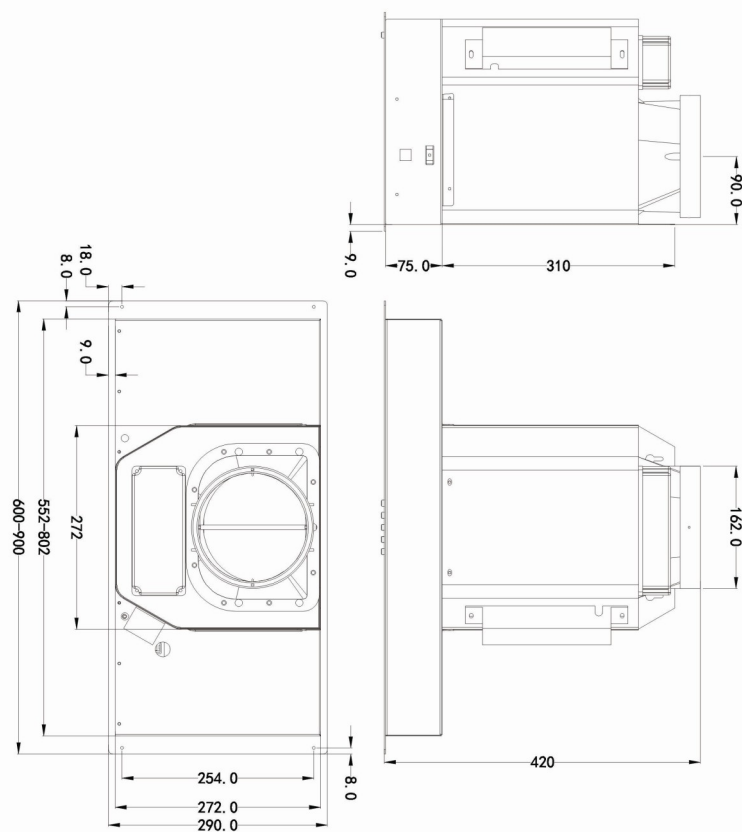

## **Cleaning & Maintenance**

Warning: Before cleaning, please ensure that the power is switched off by detaching the plug from the wall socket.

**10.1** Clean the surface of hood every week with mild soap or detergent . Avoid solvents, acid, alkali, scouring pads or powders that could irreparably damage the stainless steel surface.

**10.2** The grease filters may be washed using mild soap, detergent or degreasing agent.

**10.3** Charcoal filters cannot be cleaned and must be generally replaced after 6 months of use.

## **Specifications**

### **PUM60X**

|                   |                |
|-------------------|----------------|
| Power Supply      | 220V~240V 50Hz |
| Rated Input Power | 140W           |
| Lighting Power    | 2W×1           |
| Motor Power       | 138W           |
| Airflow           | ≥700m³/h       |
| Outlet Diameter   | 150mm          |

### **PUM90X**

|                   |                |
|-------------------|----------------|
| Power Supply      | 220V~240V 50Hz |
| Rated Input Power | 142W           |
| Lighting Power    | 2W×2           |
| Motor Power       | 138W           |
| Airflow           | ≥700m³/h       |
| Outlet Diameter   | 150mm          |

## **Contents**

|                             |    |
|-----------------------------|----|
| Introduction.....           | 1  |
| Features.....               | 2  |
| Installation.....           | 2  |
| How To Use.....             | 4  |
| Lamp Change.....            | 5  |
| Safety Information.....     | 6  |
| Trouble Shooting.....       | 7  |
| Electrical Diagram.....     | 8  |
| Specifications.....         | 9  |
| Cleaning & Maintenance..... | 10 |

## **Introduction**

**1.1** This appliance has been manufactured with materials and processes that respect the environment. We hope that you will continue this important consideration in the operation of this appliance & the disposal of the packaging materials, thank you.

**1.2** The installation work must be undertaken by a qualified technician experienced in cooker hood installation. Please connect the correct power rating (*see page 6*).

**1.3** The manufacturer disclaims all liability for any damage or injury caused as a result of not following the instructions for installation contained in the following text.

**1.4** The appliance is not intended for use by young children or infirm persons without supervision.

**1.5** Young children should be supervised to ensure that they do not play with the appliance.

**1.6** The maximum number of hobs covered by range hood should not exceed 5.

**1.7** Any modifications to the appliance, electric wire and plug is dangerous & voids the warranty.

## **Electrical Diagram**

PUM60X

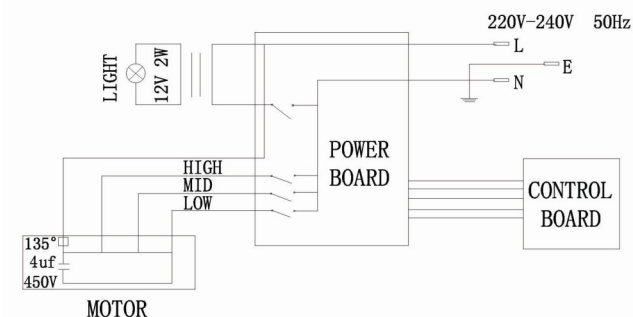

PUM90X

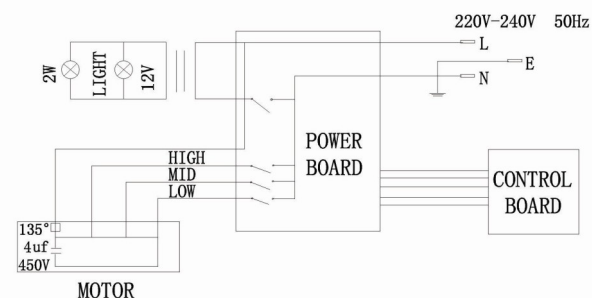

## **Troubleshooting**

If any problem occurs, please detach the plug from the socket and contact the manufacturer or its service agent or a similarly qualified person in order to avoid a hazard.

| Problem                                  | Cause   | Solution  |
|--|---|---|
| Light on, but motor does not work        | The outlet valve is blocked                             | Detach flue and duct then turn on the hood to check if the valve opens  |
|  | The capacitor has failed                                | Call for technical service  |
|  | The control switch has failed                           | Call for technical service  |
| Light does not work, motor does not work | No power supply   | Plug another appliance into the socket to confirm there is power supply                                       |
| Vibration                                | The propeller is damaged or unbalanced                  | Call for technical service  |
|  | The hood is not installed correctly                     | Review the installation instructions & check the installation again for loose screws, brackets or connections |
| Insufficient suction effect              | The distance between the hood and the cooker is too far | Check that the distance is between 650mm to 700mm   |
|  | The filters are saturated                               | Clean the filters from grease residue and replace after drying.   |

7

## **Features**

**2.1** This appliance is manufactured from top quality materials, and offers superb streamlined operation.

**2.2** With high suction power and low noise, it is designed to remove cooking fumes from your kitchen quietly & effectively.

## **Installation ( duct is not supplied)**

**3.1** The range hood should be mounted at a distance of 650-750mm from the cooking surface for safety & optimum performance (If the instructions for installation of the gas hob specify a greater distance, this has to be taken into account.) (see *pic1*). That exhaust air must not be discharged into a flue which is used for exhausting fumes from other appliances burning gas or other fuels.

**3.2** To install, drill 2 holes of Ø8mm on a sturdy wall and in line with the hood.

**3.3** Insert expanding screws into the holes.

**3.4** Fix drilling template on the wall (see *pic 2*).

**3.5** The appliance should be embedded into the wall unit or another support. This process should be carried out by 4 screws (provide with hood) suitable for the kind of unit following the instructions for the drilling of the *pic 1* holes as shown in (see *pic 3*).

**3.6** Attach the duct to the one way valve, and connect it to the

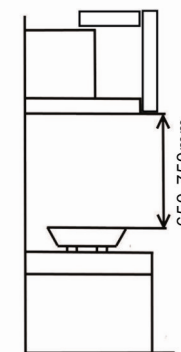

2

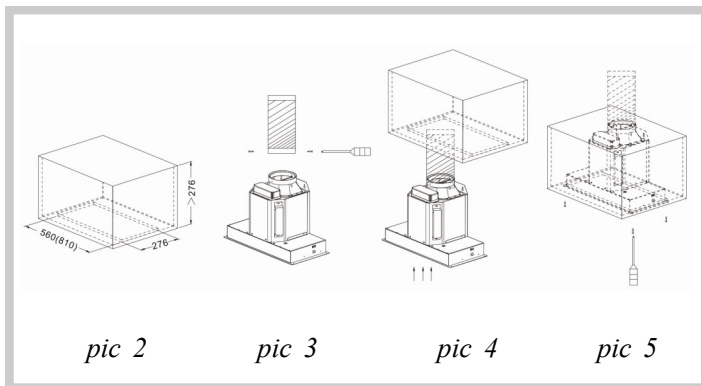

**3.7** Ensure that the wall to be installed on is sufficiently sturdy to carry the weight of the hood. It should be mounted level for best performance (*see illustration*).

**3.8** Do not connect to a common vent with other appliance such as gas heater, water heater, laundry dryer etc.

**3.9** The duct should not be bent more than  $\geq 120^\circ$  from the one way valve outlet to the kitchen vent.

**3.10** Check to make sure that the electric cord is not in contact with sharp edges of the appliance.

**3.11** Be sure that the plug is accessible after installation.

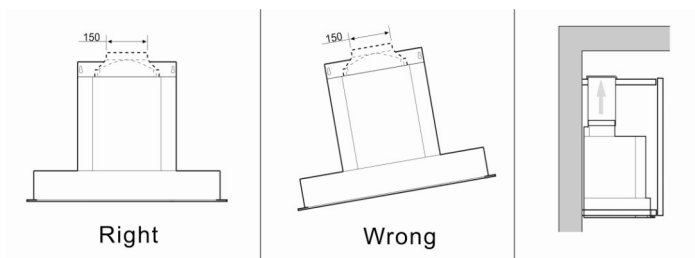

## **Safety Information**

- ◆ There must permanent & adequate ventilation of the room when operating the range hood with appliances burning gas or other fuels.
- ◆ Do not check the status of the filters when the range hood is operating, wait at least 30 minutes after switching off to avoid scalding.
- ◆ Do not touch the light within 30 minutes after appliance use.
- ◆ Avoid operating a gas cooker when there is no pan on the stove, it is a fire hazard and may cause damage to the hood filters.
- ◆ Disconnect the electrical plug prior to any maintenance.
- ◆ This appliance is not intended for use by young children and persons unless they have been adequately supervised by a responsible person to ensure that they can use the appliance safely.
- ◆ The range hood is for home use only and is not suitable for outdoor, barbecue, and other commercial applications.
- ◆ The range hood and its filter should be cleaned regularly for best performance.
- ◆ Before cleaning, please confirm that the power is switched off.
- ◆ Building regulations concerning the discharge of exhaust air have to be fulfilled.
- ◆ Don't cook with an open flame under the range hood.
- ◆ For any technical issues ensure that a suitably qualified person effects any repairs or inspection.

## **Lamp Change**

As with any maintenance on the appliance, first turn off the power supply by unplugging from the wall socket.

- 1.Remove the filters from the appliance.
- 2.Unload the screws on the stainless steel hood panel.
- 3.Remove the stainless steel panel before changing the lamp (see pic 7).
- 4.Change the lamp (LED Lamp Max.2W) and then reinstall in the reverse manner.

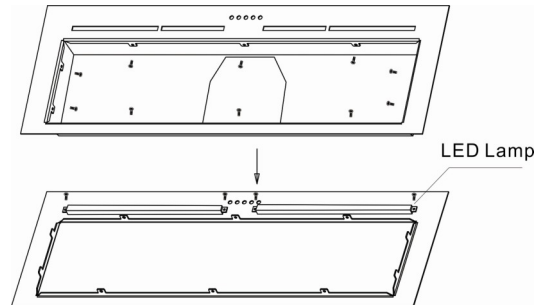

*pic 7*

## **How To Use**

### **3 Speed adjustment (see pic 6).**

- ◆ Push Stop button, and the motor will stop.
- ◆ Push the Low button, and the motor runs at low speed.
- ◆ Push the Mid button, and the motor runs at mid. speed.
- ◆ Push the High button, and the motor runs at high speed.
- ◆ Push the Light button, and the two lighting lamps illuminate. Push it again and the lamp will turn off.
- ◆ On any speed, push “T” & the delay timer will switch off the hood after 5 minutes.

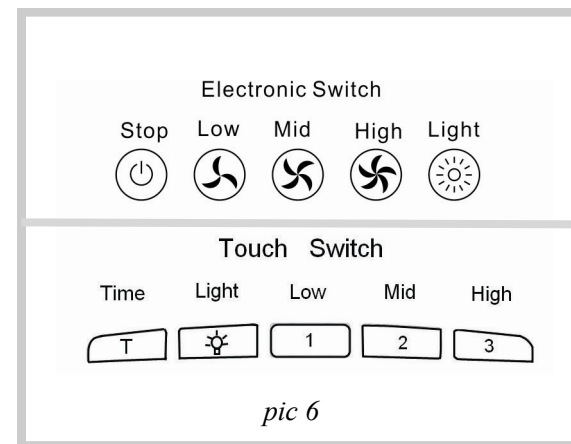

*pic 6*